

外形尺寸

单位: mm

¥SJ200-002 - 004NFU

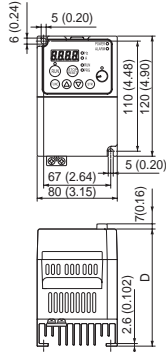

机型	D
002NFU	103(4.06)
004NFU	117(4.61)

¥SJ200-002 - 005NFEF

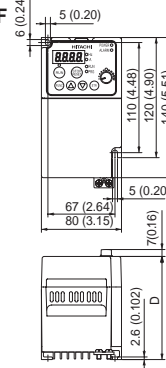

机型	D
002NFEF	103(4.06)
004NFEF	117(4.61)
005NFEF	

¥SJ200-007 - 022NFU
¥SJ200-030 - 037LFU
¥SJ200-004 - 037HFU

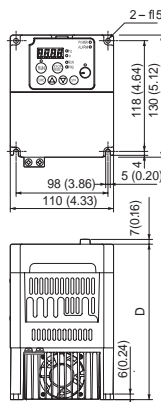

机型	D
015,022NFU	139(5.47)
004HFU	
037LFU	166(6.54)
007-037HFU	

004HFU, 007HFU : 无冷却

¥SJ200-007 - 022NFEF
¥SJ200-004 - 040HFEF

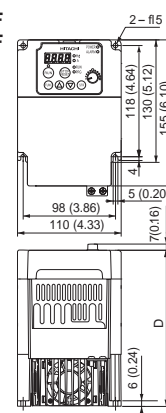

机型	D
007.011NFEF	139(5.47)
004HFEF	
015,022NFEF	166(6.54)
007-040HFEF	

007NFEF, 004HFEF, 007HFEF : 无冷却

* Potentiometer knob can be removed.

¥SJ200-055,075LFU 2-φ6
¥SJ200-055,075HFU

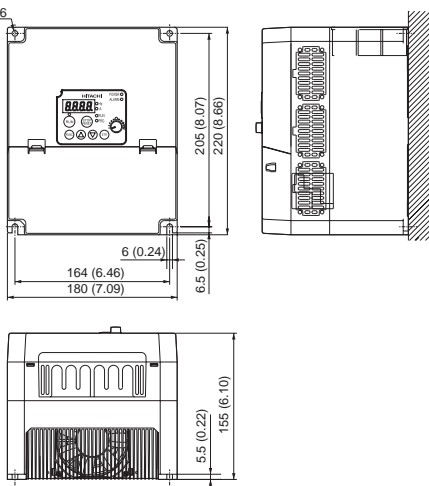

¥SJ200-055,075HFEF 2-φ6

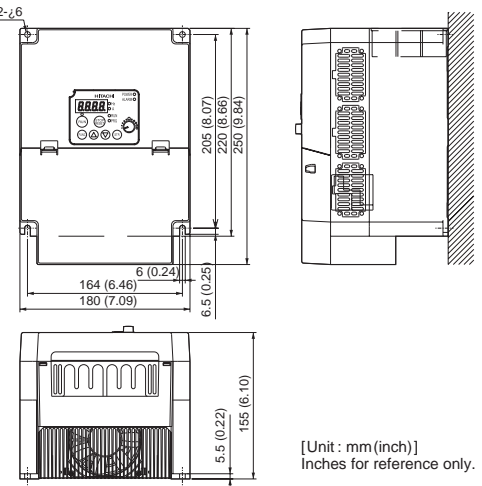

[Unit: mm (inch)]
Inches for reference only.

Keypad (digital operator), provided as standard

¥OPE - SRmini

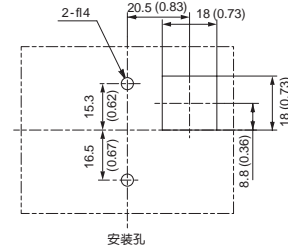
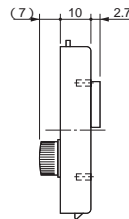
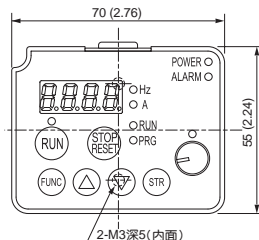

[Unit: mm (inch)]
Inches for reference only.